



National Government Constituencies Development Fund Board
Webuye East Constituency
At Webuye East Sub County HCS
P.O Box 404-50205, WEBUYE
Tel: | Cell:
Email: cdwebuyeeast@ngcdf.go.ke | Website: www.ngcdf.go.ke

16th November, 2021

OUR REF: NG-CDF/WBYEAST/LETTERS/VOL.1/032

The Chief Executive Officer
National Government Constituency Development Fund Board
P.O Box 46682 – 00100, NAIROBI

Dear Sir,

RE: CONDITIONAL APPROVAL OF WEBUYE NG-CDF PROJECT PROPOSALS FOR 2019/20 AND 2020/2021 FINANCIAL YEARS

Reference is made to the above subject.

The NG-CDF Board gave conditional approvals to Five projects in the 2019/2020 financial year amounting to Kshs. 8,790,000 and Two projects in 2020/2021 financial year of Kshs. 7,966,390.

Attached are the extracts of the NG-CDFC minutes and required documents responding to the conditional approvals accordingly.

NB: Numarambi Secondary school – Construction of the twin laboratory price has been reviewed to Kshs. 12 million of which Kshs. 9,000,000 has been approved in 2020/21 and 2021/22 financial years. Please approve the balance of Kshs. 3 million under conditional approval.

Thank You.

Yours faithfully,
For: NG – CDFC, Webuye East Constituency

MARY G.M. WANJALA 0724 286 473
FUND ACCOUNT MANAGER



Vision: Equitable social-economic development countrywide

WEBUYE EAST NG-CDFC MEETING HELD 14TH JULY 2021 AT THE NGCDF BOARDROOM AT 11:30 AM.

PRELIMINARIES

- 1 Prayer
- 2 Introduction

AGENDA

- 1 Introduction of the new Funds Account Manager
- 2 Change of Signatories to the bank account
- 3 Recruiting the Clerk of Works

The meeting was called to order by the Regional Coordinator at 11:30am with a prayer from Roselyne Wanyonyi

MEMBERS PRESENT

- | | |
|-------------------------|--------------|
| 1) Timothy Mulongo | Chairman |
| 2) Roselyne Wanyonyi | Secretary |
| 3) Isaac Namusasi | Member |
| 4) Fred S. Wanyama | Member |
| 5) Esau Wanjala Wamalwa | Member |
| 6) Maureen S. Mafunga | Member |
| 7) Nancy M. Wanyonyi | Member |
| 8) Allan Rotich | Outgoing FAM |
| 9) Mary Gorreti Wanjala | New FAM |
| 10) Peter Yegon | DCC |

IN ATTENDANCE

- | | |
|---------------------|-----------------------------|
| 1. Wilson Mumaina | Constituency Office Manager |
| 2. Martin Namawanga | Deputy Constituency Manager |
| 3. Thomas Ondweka | Regional Coordinator |
| 4. Patrick Walutila | |

1

1. WEBUYE EAST CONSTITUENCY NG-CDFC MEETING 4/2021

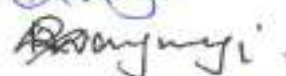
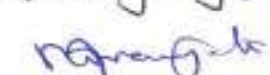
- 1 Timothy Mulongo - 
2. Roselyne Wanyonyi - 
3. Mary Gorreti Wanjala - 

NGCDF WBY.W/MIN/01/013/07/21 INTRODUCTION OF NEW FUND ACCOUNT MANAGER.

The regional Coordinator introduced the new Fund Manager to the committee and urged the committee to Cooperate and work in harmony with the new Funds Account Manager. The same was reiterated by the DCC and the entire CDFC Committee who called for unity of purpose.

It was also resolved that the outgoing Fund Account Manager will hand over to the incoming Fund Account Manager on Tuesday 20th/July/2021 at 10:00am.

NGCDF WBY.W/MIN/02/013/07/21 RECRUITING CLERK OF WORKS

The meeting deliberated and resolved to employ the Clerk of Works with immediate effect.

NGCDF WBY.W/MIN/03/013/07/21 CHANGE OF BANK SIGNATORIES

The Committee resolved to change the bank account signatories as follows:

	NAME	DESIGNATION	ID NO
1	MILDRED NASIMIYU BARASA	NSCA	13718103
2	MARY GORRETTI MACHUMA WANJALA	FAM	8110663

Mode of signing- The Funds Accounts Manager and the Sub County Accountant Mandatory, where as it was resolved that Mr Timothy Mulongo Wetiba ID NO: 34790905 and Mrs Roselyne Namwatikho Wanyonyi of ID NO: 9684456 are alternate signatories.

NGCDF WBY.W/MIN/04/015/07/21 Adjournment

There being no other business the Chairman adjourned at 1:54pm with a prayer from Mr. Walutila.

MINUTES SIGNED FOR CIRCULATION

NG- CDFC CHAIRMAN.....*[Signature]*.....DATE...16/7/2021...

NG - CDFC SECRETARY*[Signature]*.....DATE...16/7/2021...

2 | 1. WEBUYE EAST CONSTITUENCY NG-CDFC MEETING 4/2021

Mary Gorretti Machuma Wanjala - 16/7/2021

MIN. NG-CDFC 022/23/09/2021: ENGAGEMENT OF AN ACCOUNTS ASSISTANT INTERN

The Fund Account Manager reported on the successful engagement of an Accounts Assistant intern who is a resident of Maraka Ward, Holder of a University degree holder in B.COM finance option with CPA part 1.

The officer: Ms. Joyce Nasambu Mutai was engaged as from 20th September 2021 to 30th September, 2022 at a gross pay of Kshs. 25,000 where all relevant statutory shall apply. The NG-CDFC to pay an employer's NSSF contribution of Kshs. 1,080.

MIN. NG-CDFC: 023/23/09/2021: CONDITIONAL APPROVAL OF PROJECTS

The following projects were given conditional approval in 2019/20 and 2020/21 financial years but are now resolved as follows:

2020/2021 FINANCIAL YEAR – KSHS. 7,966,390

	Name Of Project	Activities	Basis of Condition	Amount Allocated	Status	Response
1	St. Paul's Kibisi Primary School	Purchase of 4 acres of land.	NG-CDFC to submit a Land Valuation Report from a Government Land Valuer	7,300,000	New	Land valuation report attached
2	Lutache Primary School	Completion of 80 Capacity Dormitory- glazing, fabrication, painting, electrical installation and finishes.	NG-CDFC to clarify the Remeasurements	666,390	On-going	Variation order and remeasurements for Kshs.1,008,000. attached
	TOTAL			7,966,390		

Name of Contract: PROPOSED ERECTION AND COMPLETION OF DORMITORY BLOCK FOR LUTACHO PRIMARY SCHOOL IN BUNGOMA COUNTY.

Contract Number: LPS/WF/001/2019-2020.

COUNTY GOVERNMENT OF BUNGOMA, DEPARTMENT OF TRANSPORT,
INFRASTRUCTURE AND PUBLIC WORKS
SITE INSTRUCTION

To: M/S FELLOW ENTERPRISES LIMITED
P.O. BOX 701-50200
BUNGOMA.

As per conditions of Contract Clause 8.1 you are hereby instructed to:

- Execute the Re-measured itemized works as specified in the contract. The extra costs will be paid from the contingency/Variation amount provided in the contract.
 1. Excavate substructure works as per the actual quantities.
 2. Execute superstructure's works as per the approval of the site engineer.
 3. The roof span to be expanded as per the working drawings.
 4. Finishes works to be done as per the new scope defined by the engineer.
 5. Mechanical works and expand the capacity of the septic tank to achieve on functionality of the hostel capacity.

Approximate Cost KShs 1,006,390.00 (To be completed by Quantity Surveyor/Engineer)

Net Addition/Deduction to/from Contract Sum Shs 0.00

Date 29/9/2021 Signed  Project Manager/Engineer



PROPOSED ERECTION AND COMPLETION OF DORMITORY BLOCK FOR LUTACHO PRIMARY SCHOOL IN BUNGOMA COUNTY

Item	Description	Unit	Quantity	Rate	Amount	Unit	Quantity	Rate	Amount	Unit	Quantity	Rate	Amount
	SUBSTRUCTURE (ALL PROVISIONAL)												
	EXCAVATION AND EARTHWORKS												
	Clearing site vegetation; grubbing up roots and filling up voids left with selected excavated material												
	Flushes shrubs, undergrowth and the like and cart away from site												
A	EXCAVATION												
	Excavating vegetable soil for preservation, average 200 mm thick		314	360	SM	50		15700			18000		2300
	Excavating Surface to reduce level		314	360	SM	80		25120			28800		3680
	Excavating Trenches; to receive foundations starting from reduced level		94	108	CM	100		9400			10800		1400
	Net exceeding 1.50m deep		85	70	CM	150		9750			10500		750
	Breaking out existing material, extra over all kinds of excavations irrespective of depth		6	6	CM	300		1800			1800		0
	Rock irrespective of class		0	0	CM	0		0			0		0
	Excavate pit for column bases starting from stripped level n.e 1.5m deep												
	Disposal												
	Excavated material: Backfilling depositing and compacting in layers maximum 150mm thick		47	50	CM	150		7050			7500		450
	Surplus excavated material removing from site		118	129	CM	150		17730			18000		300
	DISPOSAL OF WATER												
	Labour and materials, keeping excavations free from general water							10000			10000		0
	Carried to collection							95620			105400		2880

ITEM	DESCRIPTION	UNIT	QUANTITY	UNIT PRICE	TOTAL PRICE	TAX	NET TOTAL
FLANKING AND STUCCO							
A	Labour and materials, to uphold sides of excavation generally				10,000		10,000
FILLING							
Hardcore							
B	300mm thick depositing and compacting layers maximum 150mm thick in making up levels	SM	400	101,200			112,400
C	Depositng and compacting layers average 450mm thick	CM	3500	0			364,000
Murrum							
D	Blinding surfaces of fill 50 mm thick	SM	120	33,360			3,360
ANTI-TERMITE AND HERICIDE TREATMENT							
Applying "Termitol 25 EC" solution or other equal and approved sprayed evenly							
E	To surface of fill and tops of foundation walls	SM	160	40,480			4,480
CONCRETE WORK							
F	Plain mix 1:4:8 in foundation strip blinding 50mm thick	SM	400	26,000			400
G	Ditto in column bases	SM	0	0			0
Normal: Class 20/20mm² vibrated (1:2:4)							
H	Strip footing	CM	12,000	120,000			12,000
I	Column bases	CM	0	0			0
J	Columns generally	CM	0	0			0
K	Floor Beds 150 mm thick	SM	1,800	456,400			50,400
Extra over thicknessing to underside bed size 100mm thick average 200mm forming sinking in hardcore dressing polystyrene sheeting to profile							
L		LM	250	0			0
REINFORCEMENT							
Bars: high tensile steel; cold worked, B. S. 4461 including bends, hooks, tying wire, distance blocks and spacers							
M	10mm Diameter bars in any location	KG	150	45,150			8,950
N	12 mm diameter in any location	KG	150	75,900			8,800
Carried to collection							
			904,490	1,366,780			461,250

NO.	DESCRIPTION	UNIT	QTY	UNIT PRICE	TOTAL PRICE	AMOUNT	REMARKS	
	Fabric: B.S 4463							
	Reference A147: mesh 700 x 200 mm weight 2.22 kgs per square meter (Measured net no allowance made for laps); including bends, tying wire and distance blocks in any location							
A	SAWN FORMWORK TO INSITU CONCRETE							
B	Edges of floor bed 75 to 150 mm wide	SM	253	281	360	88,550	95,350	
C	Sides of strip footing	LM	98	106	150	14,700	15,900	
	WALLING	SM	0	200	150	0	30,000	
D	225mm thick walling in natural stones and mortar (1:3) DAMP PROOF MEMBRANES Polythene, 500 gauge. 150mm laps, No allowance made for laps	SM	108	180	1300	140,820	234,000	
E	Horizontal 1 No. of layer(s) over 300 mm wide PLINTH FINISHES Render, cement and sand (1:4) wood floated 12mm thick 2 No. coat work, to stone work base (ms) generally external	SM	253	281	150	37,950	42,150	
F	Painting, 3 coats black bituminous paint to generally external	SM	44	48	200	8,800	9,600	
G	Rendered surfaces external	SM	44	48	200	8,800	9,600	
H	PAVING SLABS 600x500x50mm thick slabs laid on and including 50mm (consolidated) bed of sand, jointed and jointed in cement sand 1:3 mortar V-joints	SM	59	64	1,000	59,000	64,000	
	Carried to collection					358,620	503,600	
	COLLECTION							
I	Brought forward from page 1					06520	106,400	8,980
J	Brought forward from page 2					904,490	1,366,780	4,61,290
K	Brought forward from page 3					358,620	503,600	144,980
	Total Substructures carried to Summary					1,359,830	1,974,780	6,15,150

REINFORCED CONCRETE FRAME

CONCRETE WORK

Normal Class 20/20mm Vibrated

A Beams

B Ramp and steps including all necessary patterned gills

C 150mm thick suspended slab

REINFORCEMENT

Bars high yield steel, cold worked B.S 4454 including bends, hooks, tying wire distance blocks and spacers

D 8mm diameter in any location

E 10mm ditto

F 12mm ditto

FORMWORK TO INSITU CONCRETE

G Sides and soffits of beams

H Sides of columns, vertical or battering generally

I Horizontal soffits of suspended slab

J Edges of suspended slab 75-150mm thick

A	9	11	CM	12,000		108000		32000	24,000
B	0	1	ITEM	80,000		0		80000	80,000
C	0	0	SM	0		0		0	0
D	690	950	KG	150		103500		127500	24,000
E	0	0	KG	0		0		0	0
F	1019	1200	KG	150		152850		180000	27,150
G	86	92	SM	500		43000		40000	3,000
H	0	0	SM	0		0		0	0
I	0	0	SM	0		0		0	0
J	0	0	LM	0		0		0	0
Total carried to collection						407350		565500	158,150

STAIRS BALUSTRADING

Vibrated reinforced class 20/20 aggregate as described in

		NO.	UNIT	UNIT	UNIT	UNIT	UNIT	UNIT	UNIT
A	Step & risers	0	0	CM	0	0	0	0	0
B	150mm thick horizontal suspended landing	0	0	SM	0	0	0	0	0
C	Sloping waist 175mm thick	0	0	SM	0	0	0	0	0
D	150mm thick sloping ramp	0	0	SM	0	0	0	0	0
	Sawer formwork as described to horizontal soffits of suspended								
E	Landing	0	0	SM	0	0	0	0	0
F	Sloping soffits of stair waist	0	0	SM	0	0	0	0	0
G	Sloping edge of staircase open string cut to profile of treads and risers 300mm maximum width	0	0	LM	0	0	0	0	0
H	Sloping soffits of ramp	0	0	SM	0	0	0	0	0
I	Sloping edges of ramp 75-150mm width	0	0	LM	0	0	0	0	0
J	Edges of suspended landing 75-150mm high	0	0	LM	0	0	0	0	0
K	Edges of risers 75-150mm high	0	0	LM	0	0	0	0	0
	BALUSTRADES								
L	Make on leave holes in reinforced concrete and masonry wall for 50x50x3mm balusters	0	0	NO	0	0	0	0	0
M	30X30X3mm thick square hollow section balusters welded to handrail on one side, the other built in concrete including making good in cement and sand grout at 1000mm centres overall 200mm high	0	0	LM	0	0	0	0	0
N	30X30mm thick square hollow section mid railing welded to 30x30x2mm thick hauster (ms) horizontally on both ends at 300mm	0	0	LM	0	0	0	0	0
O	100x25mm thick wrot hardwood handrail moulded and grooved and screwed to balusters (ms) and ends grouted in to concrete	0	0	LM	0	0	0	0	0
P	Extra over railing for grouting ends into concrete	0	0	NO	0	0	0	0	0
	Total Carried to collection								

Item	Unit	Quantity	Rate	Amount	Unit	Quantity	Rate	Amount	Unit	Quantity	Rate	Amount	
A	Extra over handrails for wreath	0	0	NO	0	0	0	0	0	0	0	0	
ONE UNDERCOAT TWO COATS OIL PAINT FULL GLOSS FINISH TO CROWN PAINTS OR EQUAL AND APPROVED													
B	Metal surfaces 100-200mm girth	0	0	LM	0	0	0	0	0	0	0	0	
ONE UNDERCOAT TWO COATS POLYURETHANE VARNISH													
C	Timber surfaces 100-200mm girth	0	0	LMI	0	0	0	0	0	0	0	0	
Total carried to collection													
COLLECTION													
Brought forward from page 4													
Brought forward from page 5													
Brought down fromn above													
Total Reinforced concrete carried to summary											407350	565500	158150

		MEASUREMENT	UNIT	UNIT PRICE	AMOUNT	TOTAL	UNIT PRICE	TOTAL
WALLING								
DAMP PROOF COURSES								
B.S 743, type A, bitumen hessian base 150mm laps, No allowances made for laps								
A	200mm wide, bedded in cement mortar (1:3)	0	85	LM	150	0	12750	12,750
B	150mm wide ditto	136	136	LM	150	20400	20400	0
C	100mm wide ditto	0	60	LM	150	0	9000	9,000
Smooth chisel dressed natural stone one side bedded and jointed in recessed pointing one side in cement sand mortar (1:4).								
D	Walls 200mm thick reinforced with hoop iron gauge 500 every alternate courses	0	0	SM	0	0	0	0
Medium chisel dressed natural stone one side bedded and jointed in recessed pointing one side in cement sand mortar (1:4).								
L	Walls 200mm thick reinforced with hoop iron gauge 500 every alternate courses	324	390	SM	900	291600	351000	59,400
F	Walls 150mm thick ditto	213	298	SM	500	106500	149300	42,500
G	Walls 100mm thick ditto	36	54	SM	400	14400	21600	7,200
H	Face filling to 200mm thick wall extreme height 300mm	0	0	LM	0	0	0	0
I	Form or leave 250X250mm opening in 200mm walling for permanent ventilation (n.s.)	26	26	NO	300	5200	5200	0
J	225X225mm pre-cast concrete permanent vent with mosquito	0	56	NO	50	0	2800	2,800
K	Labour and materials in saws filling 200mm thick	0	0	LM	0	0	0	0
L	40X40X3mm S.I.S horizontal rails welded to vertical sections as before described at 1000mm centres	0	0	LM	0	0	0	0
M	25X25X3mm S.I.S in-fill welded to frame in patterned grills at 200mm centres	0	0	LM	0	0	0	0
Total Walling carried to Summary					438400	571750	133,650	

Item	Unit	Quantity	Unit Price	Total Price	Estimate	Actual	Variance	
ROOFING								
Roof covering								
A	C.C1 sheets gauge 28 pre-painted galvanized iron sheets nailed onto purlins (r.i.s)	355	420	SM	1,400	497000	688000	91,000
B	Ridge covering in matching material	29	37	LM	700	20300	25900	5,600
C	Raking cutting 114 sheets	0	0	LM	0	0	0	0
Sawn cypriss								
D	100x50mm thick rafters	230	260	LM	350	80500	87500	7,000
H	150x50mm thick tie beams	182	202	LM	350	63700	70700	7,000
F	150x150mm thick Kingpost	0	0	LM	0	0	0	0
G	100x50mm thick strut and ties	330	395	LM	300	9900	118500	108,600
H	75x50mm thick under purlins	0	0	LM	0	0	0	0
I	75x50mm thick purlins	310	370	LM	300	93000	111000	18,000
J	100x50mm thick wallplate fixed to ringbeam with hoop iron and nails	61	89	LM	300	18300	20700	2,400
K	150x50mm support beam/collier plates	23	31	LM	350	8050	10650	2,600
L	200x50mm Ridge board	0	0	LM	0	0	0	0
M	Bore hole in 50mm thick timber for 12mm diameter bolts	0	0	NO	0	0	0	0
N	Make notice in reinforced concrete for 12mm diameter bolts	0	85	NO	0	0	0	0
BOARDING								
Wrought cypriss, prime grade, pressure impregnated								
O	225 x 25mm thick Fascia or barge boards	111	171	LM	350	36850	42350	3,500
P	Coffice tray racked to timber at eaves	0	0	SM	0	0	0	0
Q	Eaves/ Verge filling in 25mm thick T & G or equal and approved alternative.	67	0	SM	1,000	67000	0	67,000
R	50x 50mm bearers nailed to sawn cypriss	111	0	LM	120	13320	0	-13,320
S	Ditto plugged	111	0	LM	120	13320	0	-13,320
Total carried to collection						623240	2075500	152,260

		QTY	UNIT	PRICE	AMOUNT	QTY	UNIT	PRICE	AMOUNT	QTY	UNIT	PRICE	AMOUNT
DOORS													
JOINERY													
Frames; Wrot Mahogany													
A	150 x 50mm rebated frame (unlaboured)	48	LM	700	33600								
B	45 x 25mm quadrant	48	LM	100	4800								
C	25mm Architrave	48	LM	100	4800								
D	Ditto ranson and mullion twice laboured	0	LM	0	0								
E	20x25mm glazing boards	0	LM	0	0								
	Flush doors, B.S 459, part 2												
	Solid core flush door 45mm thick, 900 x 2400mm high, 6mm mahogany veneer facing both sides, hardwood (plying on all exposed edges with fanlight	9	NO	9500	76000								
F	Ditto size 1590x2030mm high with 1 No. 300x300mm fanlight filled with glass and approved beading all round	0	NO	0	0								
	<u>Panel Doors</u>												
	900x2400mm high mahogany paneled door to detail in single leaf	0	NO	0	0								
	<u>Standard steel door complete with all necessary ironmongery, Perimeter vent with mosquito gauze and sheet hood assembled and fixed to opening including cutting and pinning lugs to concrete or sand nodar (1:4) all primed with red oxide before fixing</u>												
G	1200x2400mm high steel casement door comprising 50x25x1.5mm cladding welded together, 32x32x1.5mm brick frame and complete with 5-lever mortice lock and fanlight	4	NO	16000	64000								
H	900x2400mm ditto	2	NO	13000	26000								
	<u>GLAZING</u>												
I	4mm thick clear sheet glass and glazing with putty to casement door in panes 0.10-0.05m squared	1	SM	1800	1800								
	TOTAL CARRIED TO COLLECTION				211000				220500				9,500

ITEM	DESCRIPTION	QTY	UNIT	PRICE	TOTAL	QTY	UNIT	PRICE	TOTAL	QTY	UNIT	PRICE	TOTAL	QTY	UNIT	PRICE	TOTAL
A	Extruder opening for 800x100mm high tan light hardwood tipping all edges left open for glass (M/S) with glass beads (M/S) on both sides including 12mm diameter vertical infill bars at 150mm centers IRONMONGERY Supply and fix the following	0	0	NO	0	0	0	0	0	0	0	0	0	0	0	0	0
B	Steel butt hinges 100mm	12	12	PRS	150	1800	1800	1800	0	0	0	0	0	0	0	0	0
C	200x25x3mm thick door fixing cramps one end bend and twice screwed to frame the other lagged and built in block work	48	48	NO	80	3840	3840	3840	0	0	0	0	0	0	0	0	0
D	Rubber door stops fixed to wall or floor	18	18	NO	100	1800	1800	1800	0	0	0	0	0	0	0	0	0
E	2 lever union mortice lock complete with set lever handle furniture	8	8	NO	2300	18400	18400	18400	0	0	0	0	0	0	0	0	0
F	5 lever union mortice lock complete with set lever handle furniture	0	0	NO	0	0	0	0	0	0	0	0	0	0	0	0	0
G	4 lever riveted steel door lock	0	0	NO	0	0	0	0	0	0	0	0	0	0	0	0	0
H	300mm diameter D handle	0	0	NO	0	0	0	0	0	0	0	0	0	0	0	0	0
I	150mm brass tower bolt	0	0	NO	0	0	0	0	0	0	0	0	0	0	0	0	0
J	Indicator bolt	0	0	NO	0	0	0	0	0	0	0	0	0	0	0	0	0
K	Mildsteel door fixing dowels 200mm long	0	0	NO	0	0	0	0	0	0	0	0	0	0	0	0	0
TOTAL CARRIED TO COLLECTION										25840		25840		0		0	

Code	Description	Quantity	Unit	Rate	Amount	Unit	Rate	Amount	Unit	Rate	Amount
PAINTING AND DECORATING											
ONE COAT ALUMINIUM HARDWOOD PRIMER TO CROWN PAINTS OR EQUAL AND APPROVED											
A	Wood surfaces before fixing not exceeding 100mm girth internally	48	LM	150	7200						0
B	Ditto 100-200mm girth	48	LM	150	0						0
ONE COAT TWO COATS OIL PAINTFUL GLOSS FINISH TO CROWN PAINTS OR EQUAL											
C	General metal surfaces over 300mm girth internal	0	SM	0	0						0
D	General surfaces of timber over 300mm girth internal	0	SM	0	0						0
E	Wood surfaces 200-300mm externally	0	LM	0	0						0
F	Ditto 0-100mm girth	0	LM	40	0						0
G	Wood frames 100-200mm internal	0	LM	60	0						0
TOTAL CARRIED TO COLLECTION											
					7200			7200			
COLLECTION											
H	Brought forward from page 11				211300			220500			8,500
I	Brought forward from page 12				25840			25840			0
J	Brought down from above				7200			7200			0
TOTAL DOORS TO SUMMARY					244040			253540			8,500

Item	Description	Quantity	Unit	Rate	Amount	Quantity	Unit	Rate	Amount	Quantity	Unit	Rate	Amount
WINDOWS													
	Precast concrete, normal, class 20/20mm vibrated												
	Cills 250x75mm thick, once sunk weathered, once throated, reinforced as necessary for hand ling, bedding, jointing and pointing in cement mortar (1:4)	52	52	LM	400	20800			20800			0	
A													
B	6mm thick ceramic tiles finish to internal surfaces of window cills 150mm grith	0	0	LM	0	0			0			0	
	Accessories												
	JOINERY												
	WROT CAMPHOR/MAHOGANY												
C	120x20mm window boards, moulded and fixed to masonry surface with screws and grounds	52	52	LM	250	13000			13000			0	
D	15x15mm quadrant bead	0	0	LM	0	0			0			0	
	WROT CYPRESS												
E	Built up pelmet: baxirado of 25x25mm foot, 10x50mm top and ends, 25x50mm bearers all assembled and fixed to wall with nails and grounds	52	52	LM	250	13000			13000			0	
F	Curtain track silent glass	0	0	LM	0	0			0			0	
	<u>Steel casement windows with one coat red oxide primer complete with accessories including and painting legs to walls and bedding all round in cement sand mortar (1:4)</u>												
G	Overall size 1500x1600mm h gh	23	23	NO	5,700	131100			131100			0	
G	Overall size 1200x650mm h gh	1	1	NO	3,500	3500			3500			0	
I	Overall size 600x850mm h gh	6	6	NO	1,900	12300			12300			0	
	Total carried to collection					193400			193400			0	

		QTY	UNIT	PRICE	AMOUNT				
Glazing									
A	4mm clear sheet glass and glazing to metal with putty Welded metal grill burglar proofing in 20mm x 20mm x 1.5mm thick S1S bars with one coat primer including welding to metal in approved pattern	56	56	SM	1 800	100800		100800	0
B	PAINTING AND DECORATING ONE UNDERCOAT TWO COATS OIL PAINTFULL GLOSS FINISH TO CROWN PAINTS OR EQUAL AND APPROVED Metal window surfaces measured overall internally	59	56	SM	2 000	112000		112000	0
C	Plastered Concrete and masonry surfaces 200 - 300mm girth	112	112	SM	200	22400		22400	0
D	Timber surfaces 100-200mm girth including priming where necessary	122	122	LM	150	18300		18300	0
E	Prepare and apply three coats polyurethane clear varnish	52	52	LM	150	7800		7800	0
F	Hinges 200-300mm girth	0	0	LM	0	0		0	0
G	Locks not exceeding 100mm internal	0	0	LM	0	0		0	0
	TOTAL CARRIED TO COLLECTION					261300		261300	0
COLLECTION									
H	Brought forward from page					93400		153400	0
I	Brought down from above					261300		261300	0
	TOTAL WINDOWS TO SUMMARY					454700		454700	0

FINISHES

FLOOR, WALL AND CEILING FINISHES

FLOORS

ITEM	DESCRIPTION	UNIT	QTY	UNIT PRICE	TOTAL	REMARKS	EST. NO.	EST. AMT.	EST. DATE
A	40mm thick Coloured cement sand screed (1:4) steel trowelled	SM	253	281	71093				
B	100x20mm screed skirting	LM	284	309	87856				
C	40x30mm plastic dividing strips set vertically in terrazzo paving WALLS	LM	0	0	0				
D	12mm thick, 2 No. coat work Plaster 1:2:6 to stone work base (note) generally to walls internal with smooth to finish.	SM	824	890	733560				
E	15mm thick, 2 No. coat work Render 1:3 to stone work base (note) generally to walls external	SM	294	100	29400				
F	Extra over walling for smooth chisel dressing with flush pointed vertical joints and recessed horizontal joints	SM	0	270	0				
G	150x150x6mm thick wall ties fixed with appropriate adhesives	SM	28	51	1428				
H	12mm thick 2 coat gauged lime(1:2:6) plaster to:- Beams Walls and Arch Prepare and apply three coats first grade silk vinyl emulsion paint	SM	0	0	0				
I	Plastered surfaces of beams	SM	0	0	0				
J	Ditto Wall and Arch CEILING	SM	0	0	0				
K	10mm thick softboard 'veldex' sheet nailed onto timber bracing (m.s)	SM	0	0	0				
L	Sawn cyprus bracing 75x50mm thick	LM	0	0	0				
M	50x50mm thick ditto	LM	0	0	0				
N	Extra over ceiling for trap door size 600x450 complete with framing	NO	0	0	0				
O	100x25mm thick moulded cornice plugged to wall	LM	0	0	0				
Total carried to collection					850200		774150	143,950	

	DESCRIPTION	UNIT	QUANTITY	UNIT PRICE	TOTAL	AMOUNT	AMOUNT	AMOUNT
	PAINTING AND DECORATING							
	THREE COATS PVA BASED EMULSION PAINT TO CROWN							
	PAINTS OR EQUAL AND APPROVED							
A	Plastered soffits of suspended slab	Sqm	0	0	0	0	0	0
B	Rendered wall surfaces externally	SM	0	90	230	0	20,700	20,700
C	Plastered wall surfaces internally	SM	824	980	230	189,520	22,700	38,180
D	Soffits of ceiling	SM	0	0	0	0	0	0
D	Keyed surfaces externally	SM	0	200	230	0	66,700	66,700
E	Timber surface 100-200mm girth	SM	0	0	0	0	0	0
	ONE UNDERCOAT ALUMINIUM HARDWOOD PRIMER TO CROWN PAINTS OR EQUAL AND APPROVED							
	Total carried to collection					189,520	316,100	125,580
	COLLECTION							
F	Brought forward from page 16					630,200	774,150	143,950
G	Brought down from above					189,520	316,100	125,580
	Total Finishes carried to Summary					819,720	1,089,250	269,530

ITEM	DESCRIPTION	UNIT	QUANTITY	UNIT PRICE	TOTAL PRICE	EST. PRICE	REMARKS
<u>SUMMARY</u>							
A	SUBSTRUCTURES				1389630	1974780	615150
B	REINFORCED CONCRETE FRAM-				4117350	566500	158,150
C	WALLING				433100	571750	133,650
D	ROOFING				1007640	1161600	153,960
E	DOORS				244040	253540	9,500
F	WINDOWS				454700	454700	0
G	FINISHES				819720	1089250	269530
TOTAL BUILDING WORKS FOR DORMITORY BLOCK AT LUTACHO PRIMARY SCHOOL					4731180	6,071,120	1339940

REMEASUREMENT ELECTRICAL WORKS - DORMITORY - LUTACHO PRIMARY SCHOOL

ITEM	LIGHT FITTINGS		UNIT	QTY	UNIT PRICE	TOTAL PRICE	EST. QUANTITY	EST. PRICE	VARIATION
	LF	FT							
Supply and install, test and the following									
LIGHTING POINTS.									
1.01	Lighting points wired with 3x1 Stran2 single core PVC/ copper cables drawn in concealed 20mm dia. HD PVC conduit for								
	a) one way switching								
	b) two way switching								
SWITCHES.									
1.02	10 Amps moulded plate flush mounted switches with screw covers as CLPSAL, BS or approved equivalent being:								
	a) 1 gang 1 way	17		NO	2,000	34,000			
	b) 1 gang 2 way	11		1,500	3,500	16,500			
	c) 2 gang 1 way		8	NO	700	5,600			
	d) 3 gang 1 way		10	NO	800	8,000			
	e) Intermediate		3	NO	900	2,700			
SOCKETS									
	a) single socket	1		NO	1,100	1,100			
	b) twin socket								
	c) DP Switch outlet	0		NO	0	0			
LIGHTING FITTINGS.									
1.03	Lighting fittings complete with lamps and all other necessary accessories.								
	a) Wall bracket LED fitting 18W	4	4	NO	1,200	4,800			
	b) 300mm diameter 1x18W HPI LED fittings as PHILLIPS or approved equivalent	28	28	NO	500	14,000			
	c) LED floodlight 40W								
	d) 100 W Tungsten Bulb/lead fitting with pin type energy saver bulb	4	4	NO	5,000	20,000			
	e) 6W spherical ball fitting	10	10	NO	250	2,500			
TOTAL CARRIED FORWARD TO COLLECTION		2	0	NO	0	120,500	0	120,500	0

MEASUREMENT

Dormitory - Lutacho Primary

Item No.	Description	Unit	Qty	Rate	Amount	Unit	Qty	Rate	Amount	Unit	Qty	Rate	Amount	Unit	Qty	Rate	Amount	
POWER POINTS.																		
2.01	13 Amps Power points wired ring comprising of 3x2.5 mm sq. single core PVC/ copper cables drawn in concealed 25mm HG PVC conduits.	NO	2	1,200	2400	NO	2	2400	2400	NO	0	0	0	NO	0	0	0	
2.02	13 Amps Moulded plate switched socket outlet with neon indicator as BG, CLIPSAI or approved equivalent being - a) Single b) Two	NO	0	0	0	NO	0	0	0	NO	0	0	0	NO	0	0	0	
2.03	25 Amps moulded plate connector as CLIPSAI, BG or approved equivalent 5mm sq. run with earth sheathed cable	NO	2	900	1800	NO	2	1800	1800	NO	0	0	0	NO	0	0	0	
2.04	Fabricate a panel from iron sheet gauge 14 to accommodate KFLC/MC/c and cutouts	NO	4	530	2120	NO	4	2120	2120	NO	0	0	0	NO	0	0	0	
2.05	45 Amps cooker control unit incorporating a 13 amps socket outlet a) Single	NO	1	5,000	5000	NO	1	5000	5000	NO	0	0	0	NO	0	0	0	
2.06	Instant hot water heater points comprising of 3x4mm sq. PVC insulated copper cables drawn in concealed 25mm diameter HG PVC conduits from DR, FR to double pole switches	NO	16	30,000	480000	NO	16	480000	480000	NO	0	0	0	NO	0	0	0	
2.07	20amps double pole switches with neon indicator and marked water heater as CLIPSAI, BG OR approved equivalent for item 2.05 above	NO	16	300	4800	NO	16	4800	4800	NO	0	0	0	NO	0	0	0	
2.08	Circuit comprising of 3x0.5mm sq. 3000V PVC/ drawn and concealed 25mm HG PVC conduits from consumer unit to cooker control unit	NO	30	300	9000	NO	30	9000	9000	NO	0	0	0	NO	0	0	0	
2.09	Instant Hot water heater	NO	16	8,000	128000	NO	16	128000	128000	NO	0	0	0	NO	0	0	0	
TOTAL CARRIED FORWARD TO COLLECTION																		
																633720	633720	0

PLANNING DEPARTMENT

Dumfries & Galloway Primary

ITEM	DESCRIPTION	QTY	UNIT	NO	UNIT PRICE	TOTAL	AMOUNT	AMOUNT	AMOUNT
Supply and install test and commission the following.									
SUB-MAIN CIRCUIT									
3.01	4x 16mm ² + 1x 16mm ² 90 PVC copper cables drawn to 38mm dia. Cable from Main Cable Loop in Box to Consumer Unit	20	LM	200	5000	6000	0		
DISTRIBUTION BOARD:									
3.02	12ways, 125 Amps SPN Flush mounted Consumer Unit complete with 125 Amps Integral SPN switch with a hinged cover as Chalfree or approved equivalent	1	NO	1100	1100	1100	0		
	3x 10 Amps SP	4	NO	250	1000	1000	0		
	6x 20 Amps SP	4	NO	300	1200	1200	0		
	6x 30 Amps SP	3	NO	350	1050	1050	0		
	4x Blanking plates	0	NO	0	0	0	0		
3.03	4x 22mm sq armoured underground cables 600/1000 v	50	LM	150	7500	7500	0		
3.04	Touching tiling and backfilling	40	LM	150	6000	6000	0		
3.05	Earthing system comprising 1500mm earth electrode c/w clamp and provide a manhole with cover	1	NO	900	900	900	0		
3.06	Cable loop in box using 914 sheet	2	NO	1500	3000	3000	0		
3.07	Cable glands for them above	6	NO	16000	106000	106000	0		
3.08	Double cut out	0	NO	0	0	0	0		
3.09	Testing and commissioning of the works	1	ITEM	20,000	20,000	20,000	0		
TOTAL CARRIED FORWARD TO COLLECTION									
						52350	-	52350	0

Sl. No.	Description	Qty	Unit	Rate	Amount	Sl. No.	Description	Qty	Unit	Rate	Amount	Sl. No.	Description	Qty	Unit	Rate	Amount
LIGHTNING PROTECTION																	
4.01	eg. Leg 25mmx12mm thick bar/copper tape as Furse P. No. TC003	15	LM	150	2250	15						15					
	MS:Std. 1 dia/Std. as Furse cat. No. 11F015 (0.1x) Lx Lx above tape to the roof	14	NO	200	2800	14	NO	200	2800			14	NO	200	2800		
4.02	Air termination spike 2000mm x 15mm diameter copper rod as Furse P. NO. RA270 complete with copper multiple point as Furse	2	NO	500	1000	2	NO	500	1000			2	NO	500	1000		
	a) Downward conductor comprising 25mm x 3mm thick bare copper tape	45	LM	300	13500	45	LM	300	13500			45	LM	300	13500		
	b) Copper square tape clamp for making crossing tape joints	2	NO	350	700	2	NO	350	700			2	NO	350	700		
	c) Copper 1 inch clamp as Furse P. NO. CM 105	2	NO	400	800	2	NO	400	800			2	NO	400	800		
	d) Steel conductors 32 mm diameter for securing the down conductors.	40	LM	400	16000	40	LM	400	16000			40	LM	400	16000		
	EARTHING																
	electrifying inspection concrete chamber 300x300x350mm with an air inspection cover to approval	2	NO	2,000	4000	2	NO	2,000	4000			2	NO	2,000	4000		
	f) 16mm nominal diameter by 1500mm threaded copper bond earth rod as Furse PNO 310 driven to ground	2	NO	1,500	3000	2	NO	1,500	3000			2	NO	1,500	3000		
	g) Earthing stud	2	NO	200	400	2	NO	200	400			2	NO	200	400		
	h) Earth electrode to downward conductor copper bond clamps as Furse CR105	2	NO	600	1200	2	NO	600	1200			2	NO	600	1200		
	Allow Rs.100,000 for smoke and fire detection system																
TOTAL CARRIED FORWARD TO COLLECTION											49350	49350	0				

DATE	DESCRIPTION	AMOUNT	CITY	UNIT	DATE	AMOUNT	CITY	UNIT	DATE	AMOUNT	CITY	UNIT	DATE	AMOUNT	CITY	UNIT
SUMMARY 1																
	Brought forward from page 1	120600				120600										0
	Brought forward from page 2	633120				633120										0
	brought forward from page 3	52350				52350										0
	Brought down from page 4	49650				49650										0
	TOTAL ELECTRICAL WORKS TO SUMMARY #	855720				855720										0

**PROPOSED MECHANICAL WORKS FOR A DORMITORY BLOCK AT LUTACHO PRIMARY
SCHOOL - BUNGOMA COUNTY**

ITEM NO	DESCRIPTION	UNIT	QUANTITY	UNIT PRICE	TOTAL PRICE	ESTIMATED QUANTITY	ESTIMATED PRICE	ESTIMATED QUANTITY	ESTIMATED PRICE
ELEMENT NO:1									
PLUMBING									
Supply, deliver, install, test and commission galvanised mild steel tubing to BS 1387 medium grade with screwed and socketed joints to BS 21 and galvanised cast iron fittings to BS 143 and 125C.									
Tenders MUST allow in their pipe work prices for all the couplings, connectors, unions, joints, etc as required in the normal running lengths of pipe work and also where necessary for pipe fixing clips, holder/bats, plugs, screws and pipe sleeves through structural members									
A	15mm diameter GMS class B pipe	SM	48	300	14,400		14,400	0	0
B	20mm diameter GMS class B pipe	SM	24	350	8,400		8,400	0	0
C	25mm diameter GMS class B pipe	SM	18	400	7,200		7,200	0	0
EXTRA OVER GMS PIPING FOR THE FOLLOWING									
G.1 ELBOW									
D	15mm diameter G.1 Elbow	CM	30	200	6,000		6,000	0	0
F	20mm diameter G.1 Elbow	CM	24	250	6,000		6,000	0	0
G	25mm diameter G.1 Elbow	CM	10	300	3,000		3,000	0	0
G.1 BENDS									
H	15mm diameter G.1 Bends	CM	30	200	6,000		6,000	0	0
I	20mm diameter G.1 Bends	CM	30	150	4,500		4,500	0	0
J	25mm diameter G.1 Bends	CM	10	200	2,000		2,000	0	0
TOTAL CARRIED TO SUMMARY PAGE					57,500		57,500	0	0

	GATE VALVE										
A	15mm diameter approved high pressure cast brass, full way gate valve to BS 1212 class 125, with wheel head, non-rising spindle, guided wedge and tapered stubs threads as "REGLER" or equal to be approved	4	4	SM	150	600	600	0			
B	20mm diameter ditto	2	2	LM	183	380	350	0			
C	25mm diameter ditto	2	2	LM	210	420	420	0			
	COPPER TUBING										
D	15mm diameter good quality copper tubing to BS 659 about 300mm long, bent as required, including brass back nuts to BS 854 and jointing to tube	13	13	SM	250	3,250	3,250	0			
	ELEVATED WATER STORAGE TANK										
E	Plastic water storage tank as made by "ROTO" capacity 5000 litres, size 1542x1442mm diameter model CV92, complete with 15mm inlet connection, 20mm outlet connection and all necessary accessories of equal approved, hoisted on a 6M steel tower (m.s.)	1	1	NO	6,000	6,000	6000	0			
	Soap dispenser,										
F	Soap dispenser, capacity 1.35litres complete with plastic rawl plug, fixing screws, lock and key complete with initial fill of soap gel. The soap dispenser to be as ZALFON'S mark 7 model, size 125x100x290mm high or approved equivalent.	0	0	SM	0	0	0	0			
	Soap Dish										
G	Semi recessed soap dish size 150x150mm as Twyford's built in soap and sponger tray cat NO. VC 53112 W/P or equal and approved.	0	0	NO	0	0	0	0			
	ROBE HOOK										
H	Robe hook in vitreous china mounted to concealed screw to wall wedges as Twyford's "ECLIPSE" accessories or equal and approved	0	0	NO	0	0	0	0			
	TOTAL CARRIED TO SUMMARY PAGE										
		0	0	NO	0	0	10,630	0	10,630	0	0

ELEMENT NO 2

SAINTARY FITTINGS

Supply deliver install, test and commission the following sanitary fittings, including their support brackets, fixing screws etc and connection to water supply and wastel drainage.

<p>A Squatting water closet ensuit while in colour comprising of W/C bowl with horizontal outlet, W/C connector, 9litres low level ceramic cistern, with internal overflow system, 75mm diameter side inlet ball valve, plastic flush pipe, inlet connector, cistern supports, fixing screws, seat & cover and pedestal white vitreous china clay wash hand basin c/w 20mm diameter pillar tap, 12mm diameter bottle trap plus all accessories. All to be as Teyfords Oriental or approved equivalent</p>	0	0	0	0	0	0
<p>B 15mm shower rosy</p>	0	4	5,000	0	20000	20,000
<p>C Twyford mirror Re. NO. 5838-SSO of plain of plain bevelled glass plate size 420x600mmx6mm thick, supplied with dome headed chrome plated fixing screws stainless steel fixing brackets or equal to be approved</p>	0	2	2,000	0	4000	4,000
<p>D DHQBI SINK Single bowl, single drainer heavy duty stainless steel Sink as ASL, complete with wall mounted heavy pattern polished brass 2NO. 15 mm bio tap, 2NO. 40mm diameter chrome plated bottle trap with extension pipe to wall, chrome plated chain waste, plug and all accessories</p>	9	9	12,000	108000	108000	0
<p>E BOREHOLE Carefully carry out necessary flushing of the borehole to remove silt and make good at the affector pipework including connections and fittings</p>	1	1	50,000	50000	50000	0
<p>F Water taps PEGLER</p>	0	8	500	0	4000	0
<p>TOTAL CARRIED TO SUMMARY PAGE</p>				159000	185000	28,000

ITEM NO.	DESCRIPTION	QTY	UNIT	NO	PRICE	AMOUNT	AMOUNT	AMOUNT
ELEMENT NO. 3 INTERNAL DRAINAGE Supply, deliver, install, test and commission the following drainage Tenders MUST allow in their prices for all couplings, joints, connectors, etc. the entire installation to BS 5672. UPVC SOIL SYSTEM CONFORMING TO BS 4515 AND 4660.								
A	Pvc Waste pipe bend size 150mm diameter	0	30	LM	RD	0	2400	2,400
A	Pvc Waste pipe bend size 100mm diameter	30	70	LM	50	1500	3500	2,000
E	Pvc waste pipe size 50mm diameter HWG	12	12	NO	90	960	960	0
F	Pvc waste pipe size 32mm diameter HWG	12	12	NO	100	1200	1200	0
G	Pvc Tee with plug size 32mm diameter	4	4	NO	60	240	240	0
G	Pvc Tee with plug size 50mm diameter	4	4	NO	160	640	640	0
H	Pvc pipe sweep bend size 50mm diameter	8	6	NO	120	720	720	0
I	Pvc sweep bend size 32mm diameter	10	10	NO	140	1400	1400	0
J	PVC vent cowl 100mm	1	1	NO	140	140	140	0
GROUND WATER STORAGE TANK Plastic water storage tank as made by "ROTO" capacity 10000Litres size 1870x1830mmx1442mm diameter model CV92, complete with 15mm inlet connection, 20mm outlet connection and all necessary accessories of equal approved quality on a suspended slab (measure separately)								
K	TOTAL CARRIED TO SUMMARY PAGE	0	0	NO	120,000	6800	11200	4,400

NO.	DESCRIPTION	UNIT	QTY	UNIT PRICE	TOTAL	AMOUNT	TOTAL	
FLOOR TRAP								
A	PVC floor trap 100x50mm as METRO Complete with cover grating to match floor finish or equal approval.	6	6	NO	250	1500	1500	
	GULLEY TRAPS							
B	GULLEY TRAPS complete with excavation size 300x300x450mm, masonry walling and precast reinforced concrete cover in rebate or equal.	2	2	NO	450	900	900	
	MANHOLE							
C	Construct manhole size 1500x1000x1500mm deep as to be instructed benching to bases and plaster with water proof cement complete with manhole cover.	0	0	NO	0	0	0	
	STEEL TOWER							
D	Steel tower to Engineer's design to support appropriate number of elevated water tanks.	1	1	NO	100,000	100,000	100,000	
	BALL VALVE							
E	15mm diameter threaded brass stem, low pressure ball valve with delayed action to MOH pattern, with 25mm shank G.I socket and back nuts, complete with silencer rod 400 long or equal approved.	1	1	NO	300	300	300	
	Water closet (W/C) Pan							
F	Low level water closet suite in approved colour comprising of W/C bowl, trap connector, heavy duty matching plastic seat and cover with metal top fixed chrome plated hinges. The water closet to be screwed and secured to floor or wall and complete with horizontal outlet to BS 3402 with 7.5 litre valveless ceramic cistern and fittings including siphon, 15mm diameter side inlet ball valve, 20mm diameter side overflow, plastic flush bend, inlet connection and chrome plated lever. As twyords classic or approved equivalent.	0	4	NO	12,000	0	48,000	
TOTAL CARRIED TO SUMMARY PAGE						102,700	150700	48,000

Item No.	Description	QTY	UNIT	PRICE	TOTAL	UNIT PRICE	TOTAL
ELEMENT NO. 4							
PORTABLE FIRE EXTINGUISHER							
	Supply deliver, test set to work commission the following fire appliances complete with wall brackets, charge horns, safety pins etc to meet the stated BS requirement as called for in the specifications.						
A	9 litres capacity water/co2 fire extinguishers to BS 5423 as manufactured by mather and platt complete with operating valve and all accessories	0	NO	7,500	0	0	0
B	4.5kg portable co2 gas extinguishers to BS 5915 as manufactured by mather and platt complete with and all accessories	0	NO	12,000	0	0	0
C	9 kg dry chemical powder fire extinguishers to BS 5424 as manufactured by mather and platt complete with operating valve and all accessories	0	NO	15,000	0	0	0
D	11.9 wall mounted hand operated alarm bell (COONG) designed to BS 1721	0	NO	4,500	0	0	0
E	Fire instructions notices	0	NO	500	0	0	0
F	Fire Exist signs	0	NO	800	0	0	0
EXCAVATION							
G	Allow for the excavation of the trench to lay drainage pipes up to 160mm diameter. The trench to be average 300x600mm but not exceeding 1000mm deep including backing trench approximate length 36m	0	LM	150	0	5,400	5,400
TOTAL CARRIED TO SUMMARY PAGE					0	5,400	5,400

LABOUR AND MATERIAL									
A	Form or leave hole in 100mm reinforced concrete worktop 425mm wide for wash hand basin and make good	0	0	NO	120	0	0	0	0
B	Form or leave hole 200mm thick natural stone wall for large pipe and make good	0	0	NO	150	0	0	0	0
C	Ditto small pipe	0	0	NO	50	0	0	0	0
D	Form or leave hole in 100mm thick natural stone walling for small pipe and make good	0	0	NO	150	0	0	0	0
E	Cut horizontal or vertical chase in natural stone walling for pipes and make good	0	0	LM	120	0	0	0	0
F	Ditto for large pipes	0	0	LM	260	0	0	0	0
G	Building in ends of 100mm diameter pipes to manholes	0	0	NO	250	0	0	0	0
H	150mm diameter ditto	0	0	NO	400	0	0	0	0
		0	0			0	0	0	0

SUMMARY 1					
CARRIED FROM PAGE 1			57500	57500	0
CARRIED FROM PAGE 2			11900	11900	0
CARRIED FROM PAGE 3			10630	10630	0
CARRIED FROM PAGE 4			158000	188000	28,000
CARRIED FROM PAGE 5			6800	11200	4,400
CARRIED FROM PAGE 6			102700	150700	48,000
CARRIED FROM PAGE 7			0	5400	5,400
CARRIED FROM PAGE 8			0	0	0
TOTAL MECHANICAL WORKS TO GRAND SUMMARY			347630	433330	85260

REMEASUREMENT OF 200 PERSONS SEPTIC TANK AND SOAKPIT - LITACHIO PRIMARY SCHOOL

ITEM	DESCRIPTION	QTY	UNIT	AMOUNT	TOTAL	AMOUNT	TOTAL
SEPTIC TANK - 200 PERSONS							
Site clearance							
A	Clear site for sewage treatment works of all bushes, scrub, weeds, small trees grass etc. to be cut and dispose as directed by the DR	0	SM	0	0	0	0
Excavations							
B	Excavate pit for septic tank starting from ground level not exceeding 1.5m deep backfill around the septic tank after construction and dispose surplus material as directed by the DR	49	CM	50	2,450	2,450	0
C	Excavate pit for septic tank starting from excavated level exceeding 1.5m and not exceeding 3.0m deep, backfill around the septic tank after construction and dispose surplus material as directed by the DR	48	CM	100	4,800	4,800	0
D	Allow for pumping and storing to sides of excavation as before described	1	ITEM	10,000	10,000	10,000	0
E	Allow for keeping all excavations free from water including spring and running water as before described	1	ITEM	10,000	10,000	10,000	0
FILLING							
F	Return fill and rain selected excavated materials around foundations	36	CM	150	5,400	5,400	0
G	Load and cart away surplus excavated materials from site	137	CM	200	27,400	27,400	0
CONSTRUCTION							
H	Provide, lay and work 50mm thick concrete (1:1.5) blinding	35	SM	400	14,000	14,000	0
I	Benching average 200mm high to manhole size 600 x 600mm internally including forming 100mm diameter half round straight channels the work finished with 10mm sulphate resisting water proof cement and sand 0:3 screed steel rows	7	MQ	2,000	14,000	14,000	0
J	Provide place and vibrate 200mm thick reinforced concrete class 20(20/112:4)	35	SM	2,400	84,000	84,000	0
K	Provide place and vibrate 750mm thick reinforced concrete class 20(20/112:4) in suspended slab	35	SM	1,800	63,000	63,000	0
L	Provide place and vibrate 200mm thick reinforced concrete class 20(20/112:4) in scum baffle wall	8	SM	2,400	19,200	19,200	0
TOTAL CARRIED TO COLLECTION				264,350	264,350	0	0

ITEM	DESCRIPTION	UNIT	QUANTITY	UNIT PRICE	TOTAL PRICE	AMOUNT	AMOUNT	AMOUNT
A	Provide place and work 200mm thick reinforced concrete class 20/20 (1:2:4) in concrete wall	S/M	0	0	0			0
B	225mm thick natural stone walling bedded and jointed in 1:3 cement sand mortar	S/M	51	1,400	71,400		71,400	4,200
C	Provide place and vibrate 200mm thick reinforced concrete class 20/20 (1:2:4) in Piers	C/M	1	12,000	12,000		12,000	0
	TOTAL CARRIED TO COLLECTION				83,400		83,400	4,200
	COLLECTION PAGE							
	TOTAL CARRIED FORWARD FROM PAGE 1				254,350		254,350	0
	TOTAL BROUGHT DOWN FROM ABOVE				83,400		83,400	4,200
	TOTAL CARRIED TO SUMMARY PAGE				337,750		341,950	4,200

	REINFORCEMENT								
	Bars high yield steel cold worked B.S. 4461 including bends, hooks, tying wire, distance blocks and spacers								
C	Ditto 4mm diameter bars	60	74	KG	150	9,900	11,100	1,200	
D	Ditto 10mm ditto	120	136	KG	150	19,350	20,400	1,050	
E	Ditto 12mm ditto	396	410	KG	150	59,250	61,500	2,250	
F	3/8" mesh 1961 No 65 Formwork	35	42	KG	300	10,500	12,600	2,100	
G	Provide and fix sawn timber formwork to edges of bed between 150 and 225mm high	25	32	LM	130	5,280	4160	700	
H	Ditto to soffit of suspended slab	35	40	SM	500	11,480	20,500	8,520	
I	Provide and fix sawn timber formwork to sides and soffits of beams	7	9	SM	500	3,500	4,500	1,000	
J	Provide and fix sawn timber formwork to edges of slab between 75-150mm high	25	32	LM	150	3,900	4,800	900	
K	Sides and soffits of scum baffle and wells	15	18	SM	500	7,500	9,000	1,500	
L	Boxing Formwork to form opening size 800 x 4500 x 150mm thick for manhole cover and frame (in situ) including painting filler to form rebate	2	4	NO	1,200	2,400	4,800	2,400	
	Ditto opening size 450x450mm	2	4	NO	2,500	5,000	10,000	5,000	
	FINISHES								
	<u>15mm thick sulphate water resisting cement and sand 1:4 plaster finished smooth for:</u>								
M	Walls internally	18	86	SM	400	31,200	54,400	3,200	
N	Ditto Externally	76	86	SM	400	31,200	54,400	3,200	
O	Provide and apply 25mm thick screed (1:3) to slab (top & bottom)	70	86	SM	400	28,000	36,200	7,200	
P	Horizontal and vertical sides of scum baffle walls and beams	72	30	SM	400	8,800	12,000	3,200	
	Metal Works:								
Q	Galvanised man-hole steel iron to B.S. 1247 with no concrete clow-work and making good.	2	3	NO	200	400	600	200	
	TOTAL CARRIED TO COLLECTION					235,780	279,460	42,700	

ITEM	DESCRIPTION	UNIT	QTY	UNIT PRICE	TOTAL PRICE	AMOUNT	TOTAL PRICE	AMOUNT
	<u>Cast from manhole cover and frame to B.S. manufacture by East Africa</u> <u>Foundry Works or other equal and approve</u>							
A	600mm x 650mm medium duty grade B rectangular manhole cover and frame including bedding frame in cement mortar and setting cover in grease and coating all surfaces with bituminous paint		5	NO	3000	15,000	16000	3,000
B	Ditto size 450x450mm a.s.d		2	NO	1500	3,000	4500	1,500
	HOLES							
C	Cut or leave hole through 200mm stone walling for large pipe and make good		4	NO	100	400	500	100
	TOTAL CARRIED TO COLLECTION					18,400	23,000	4,600
	COLLECTION							
	TOTAL CARRIED FORWARD FROM PAGE 4					235,750	279,460	42,700
	TOTAL BROUGHT DOWN FROM ABOVE					18,400	25,000	4,600
	TOTAL CARRIED TO SUMMARY PAGE 3					254,150	302,460	48,300

ITEM NO.	DESCRIPTION	UNIT	QUANTITY	UNIT PRICE	TOTAL PRICE	AMOUNT	AMOUNT	AMOUNT	
SEWERLINE									
SITE CLEARANCE									
EXCAVATIONS									
A	Excavate for 160mm UPVC drainage pipe part return fill and rain and remaining pad cut away (to be delineated on site)	M ²	114	114	LM	200	22,800	22800	0
B	Extra over excavation for excavation in rock class 1	M ²	20	20	LM	500	10,000	10000	0
PIPE CONSTRUCTION									
C	Provide lay and joint in trench dia 160mm Golden Brown CI ASS 41 Sewer pipe in flexible joints (rubber ring or lip seal joint) including 100mm approved manrain bed and haunch	M	120	120	LM	500	60,000	60000	0
D	MANHOLE								
D	Construct manhole size 600x600x1100mm deep with medium duty cover as to be instructed benchmark to bases and plaster with water proof cement complete with manhole cover	N	7	7	N	12000	84,000	84000	0
TOTAL CARRIED TO SUMMARY PAGE 3									
SUMMARY									
TOTAL CARRIED FORWARD FROM PAGE 2									
TOTAL CARRIED FORWARD FROM PAGE 4									
TOTAL BROUGHT DOWN FROM ABOVE									
TOTAL SEPTIC TANK TO SUMMARY									
						777,710	830710		52,500

SOAKPITS

Construct the following in 1no soak pit overall size 1500mm diameter x 600mm deep

A	Excavate for soakpit starting from ground level not exceeding 1.5m backfill after constructing soakpit and dispose excess material as directed by the DR	7	17	CM	150	1,050	2650	1,500
B	Ditto Excavating 1.5m but not exceeding 3.0m deep	7	17	CM	200	1,400	3400	2,000
C	Ditto Exceeding 3.0m but not exceeding 4.5m deep	7	17	CM	200	1,400	3400	2,000
D	Ditto Exceeding 4.5m but not exceeding 6.0m deep	7	17	CM	200	1,400	3400	2,000
E	Extra over excavation for excavating 1:1 rock	15	15	CM	1000	15,000	15000	0
F	Allow for planking and shoring to sides of excavation as described	4	4	ITEM	5000	5,000	5000	0
G	Allow for keuring all excavations free from water including spring and running water	1	1	ITEM	5000	5,000	5000	0
H	Hardcore fill to three quarters full of the excavated pit	25	60	CM	100	1,500	5000	3,450
I	Backfill approved excavated materials	7	17	CM	180	1,260	3060	1,800
J	Plain concrete (1:4:8) as Described in:- 50mm thick blinding to receive strip foundation Vibrated reinforced concrete (1:2:4) class 20/20mm in: 200mm thick strip foundation	3	8	SM	400	1,200	2400	1,200
K	Steel Reinforcement	3	6	SM	1400	3,000	8400	5,400
L	Mild steel to B.S. 4445 as described in:- 100mm diameter bars	25	50	KG	150	2,700	7500	4,800
M	Walling 200mm med um dressed natural stone walling laid in cement sand 1:3 mortar	5	10	SM	400	2,000	4000	2,000
N	15mm thick sulphate resisting water proof cement and sand 1:4 plaster trowel smooth for: walls	5	10	SM	400	2,000	4000	2,000
O	Curb leave holes through 200mm stone walling for large pipes and make good	2	2	NO	200	400	400	0
P	Allow for testing the integrating soil system by an approved method	1	1	Item	5000	5,000	5000	0
TOTAL FOR 1NO SOAKPIT						49,360	77510	28,150

TOTAL CARRIED FROM PAGE 3						777720	830210	52,500.0
TOTAL CARRIED FROM PAGE 4						45360	77510	28,150.0
TOTAL FOR INO SEPTIC TANK AND SOAKPIT						827,070	907,720	80,65

A Allow a provisional sum of Kahs500000.00 (Five Hundred Thousand) only for contingencies			500000	0	-500000
Total PC and Provisional sums to Grand Summary			500000	0	-500000

Bill No.	Description	Quantity	Unit Price	Amount	Retention	Balance
GRAND SUMMARY						
A	Bill No. 1 Preliminaries			1100000	1100000	0
B	Bill No. 2 Builders' works			4731180	8,071,120	1339940
C	Bill No. 3 Electrical works			855720	855,720	0
D	Bill No. 4 Mechanical			347530	433330	85800
E	Bill No. 5 Septic tank			627290	937720	80650
F	Bill No. 5 PC and Provisional Sums			500000	0	-500000
	Sub-Total			8361720	9,367,890	1006390
	Add 16% VAT to be paid to commissioner of VAT			0	0	0
TOTAL FOR ERECTION AND COMPLETION OF DORMITORY BLOCK -LUTACHO PRIMARY SCHOOL				8361720	9,367,890	1006390



MINISTRY OF LANDS AND PHYSICAL PLANNING



COUNTY LANDS OFFICE
BUNGOMA
P.O. BOX 382
BUNGOMA

REF: BGM/LNDS/VALGEN/VOL1/035

Date: 17th February 2021

REPORT AND VALUATION

TITLE No. NDIVISI/MAKUSELWA/529

BUNGOMA EAST SUB COUNTY

TERMS OF REFERENCE

Duly instructed by the Fund Account Manager, National Government Constituencies Development Fund, Webuye East Constituency vide letter dated 8th February, 2020 referenced 221/CDF/WBY. EASI.FAM.COORE we inspected the above referenced property with a view of advising on the current market value for purchase purpose.

Here below is our report and valuation:-

A. M. M.

DATE OF INSPECTION

11th February, 2021

SITUATION

The property is located along Webuye-Kitale road in Kibisi sub location, Namarambi locationa boudering St. Paul Kibisi Primary School to the north.

REGISTERED OWNER

The property is registered in the name of **DAVID MURUNGA MUSIMBI**

AREA

The property extends to 1.54 ha. or 3.8 acres

ENCUMBRANCES

Nil as at 8th February, 2021

USER

Agriculture and residential

THE PARCEL

This is irregular in shape, level in gradient of loam soils boundaries marked by survey beacons.

IMPROVEMENTS

The improvements described here below are as pinpointed by the head teacher of St. Paul Kibisi Primary school and CDF representative.

(a) Residential house

The house is constructed with bricks walls, gci sheets roof, metal and timber doors, glazed windows with cement screed floor.

The building accommodates 3No. bed rooms, sitting room, bathroom and kitchen.

The building has plinth area of 756sqft.

- (b) Other improvements includes 2No. bed rooms temporary house with a plinth area of 180sqft.
- (c) The subject property is planted with approximately 80No. eucalyptus trees of different sizes and age.

It is noted that the survey mutation is inter changed on the ground and It is advised that the error be rectified.

VALUATION

In regard to the above report and remarks we are of the opinion that the current open market value for purchase purpose on title No. Ndivisi/Makuselwa/3431, from all encumbrances can be fairly stated as at todays date as **Kenya Shillings Nine Million (Ksh.9,000,000/=) only.** break down as follows:-

(a) Land	- Kshs. 7,000,000/=
(b) Buildings	- Kshs. 1,800,000/=
(c) Trees	- Kshs. 200,000/=
(d) TOTAL VALUE	<u>Kshs. 9,000,000/=</u>



S.W. KANYI
COUNTY LAND VALUER
BUNGOMA COUNTY

REPUBLIC OF KENYA

THE LAND CONTROL ACT

No. 3 of 2012 (Section 108)

(Cap. 300) (Repealed)

CERTIFICATE OF OFFICIAL SEARCH

TITLE NO. NAKVI 1574 (S.E. 1/A) 524 SEARCH NO. 524

On the 12th day of February 2020 the following

were the subsisting entries on the register of the above-mentioned title:

PART A - PROPERTY SECTIONS (EASEMENT, ETC)

Nature of Title: RESERVE

Approximate area: (1.85) HA ONE POINT EIGHT FIVE TO

PART B - PROPRIETORSHIP SECTION

Name and Address of the Proprietor:-

3 312 CT - NAYIA MURUGA MUSIMBI

5 389-6815 - TIEE ASSN WUSO

Inhibitions, Cautions and Restriction:-

/

PART C - ENCUMBRANCES SECTION (LEASE, CHARGE, ETC)

/

The following applications are pending:

/

The certified copies requested are attached.

The minimum fee KSh. 500 (Five hundred only)

Date this 12th day of Feb 2020



To: THE LAND REGISTRAR,
Barito area District Land Registry.

P.O. Box: _____

524 attached hereto.

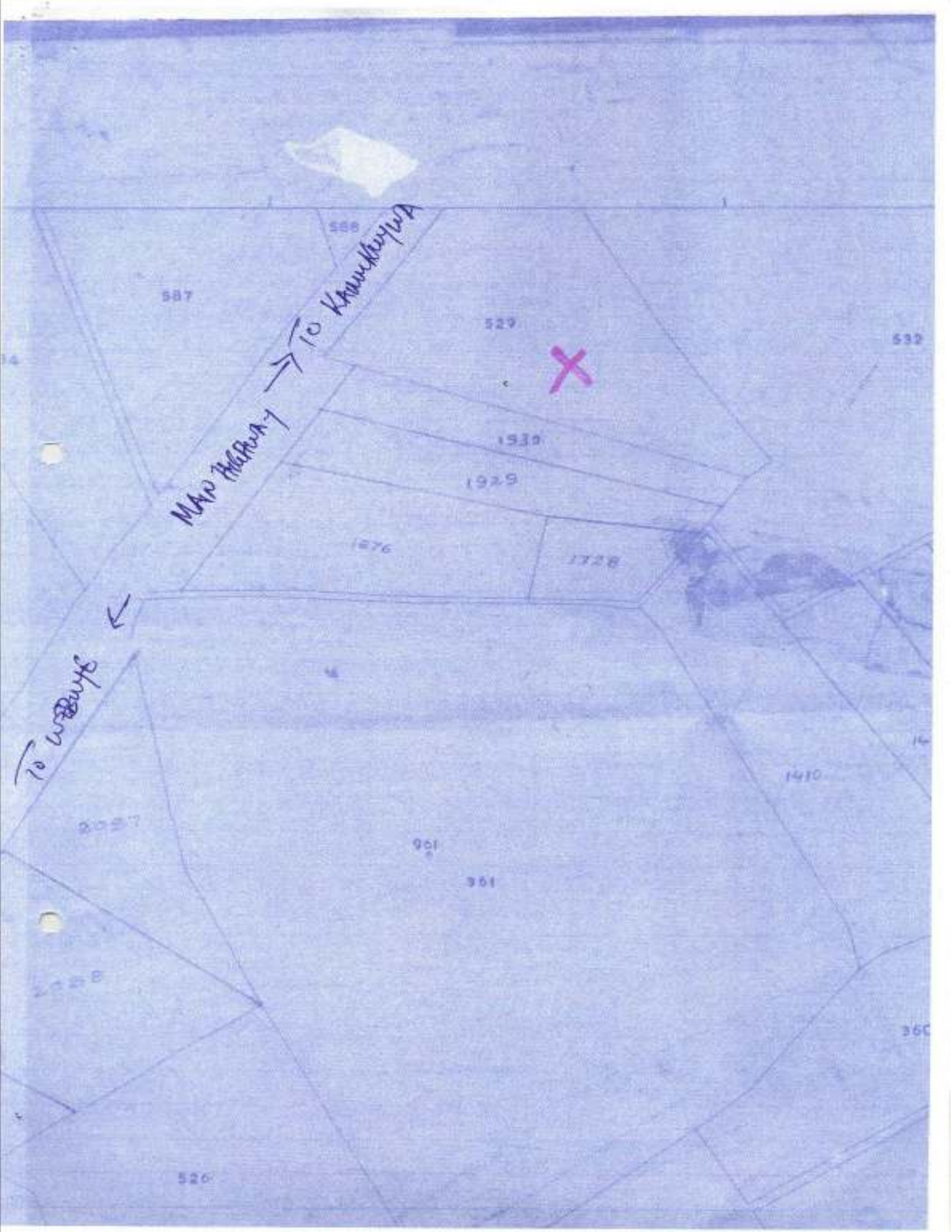

MAN HIGHWAY → TO KANKUPUA

← TO WAIKAI



587

586

529

532

1539

1929

1876

1728

1410

2097

961

361

2098

526

360